



Breathe Health, Breathe  
Molecular Hydrogen

[www.HydrogenTherapyH2E.com](http://www.HydrogenTherapyH2E.com)



## USER MANUAL

### Hydrogen Oxygen Health Care Machine

Hydro Nova 1500ml  
Hydro Gen 1200ml



- Please read the manual carefully before using the product and keep it properly
- Warm prompt: this product cannot be used as a substitute for medical devices or drugs







## Contents

1 Notes for Use (Please read) .....	2
2 Technical parameters .....	5
3 Environmental conditions of the operation place .....	5
4 Instructions for Use .....	6
5 Product introduction and operation instructions .....	7
6 Maintenance and cleaning .....	14
7 Transport and Storage .....	15
8 Common faults .....	16
9 Pollution Control Labels of Electronic Information Products .....	18
10 Liability of Manufacturer .....	20
11 Packing List .....	21
Warranty card	





## 1. Notes for Use (Please read)

In order to ensure the safe and effective use of Hydrogen Health Care Machine in good condition, please read the following notes carefully first, and then read the operating instructions of the product carefully.

### ⚠ WARNING





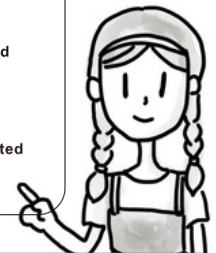

	When using, there shall be no ignition device, or action generating static electricity to prevent explosion!		The collection of hydrogen and oxygen is prohibited; Other uses are prohibited.
	When this product is in use, smoking is prohibited, and it shall be kept away from open fire!		No sundries and oil containers shall be placed on the top of the product.
	When using, it is forbidden to tilt, invert and recline this product.		Please use distilled water or purified water, and please add proper amount distilled water or purified water before starting it for use!
	When this product is used by children or persons with impaired behavior, there shall be guardians to attend on them;		Please use distilled or purified water. Please add an appropriate amount of distilled or purified water before turning it on.

### ⚠ ILLUSTRATION



	There is something to remind you 「caution」 「danger」 「warning」		Compulsory or specified sexual acts
	Prohibited acts		Disaggregation prohibited



**Do not use in the following environments**

 High temperature and humidity environment	 Oily environment	 Bathroom and other water environment	 Water vapor rich environment
 Dusty environment	 Flammable and explosive (gas or dust) environment	 Environment with strong electromagnetic interference	

**Please observe the following prohibitions, otherwise it may cause failure or danger.**

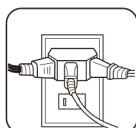
 Do not splash water or other liquid onto the body	 Do not force, twist or tie the power cord	 Do not touch and plug with wet hands	 In case of lightning, power on shall be terminated and power plug shall be unplugged
 Do not use sharp objects to touch and scratch the screen	 Do not share a socket with other equipment	 Do not place heavy objects on the power line	 No heavy blows

**Warnings:**

- Avoid generating any sparks near this product during use, including sparks caused by various frictional static electricity;
- Children over eight years old and persons with reduced physical, sensory or mental abilities or lack of experience and knowledge should use this product under the supervision or guidance of a qualified person.

**Warnings:**

- Minors and children are not allowed to operate, play, or use this product;
- Product cleaning and maintenance must not be performed by children without supervision;
- The use and purpose of the machine cannot be changed, and hydrogen and oxygen cannot be collected for breathing or other uses (for example, the use of oxygen bags is prohibited).

- Please use it in a ventilated environment;
- Power shall be cut off after each use (turn off the main power supply);
- When this product is not in use, please turn off the main switch and unplug the power plug.
- When moving the main engine, please do not place it in the place with abnormal high temperature, or it may cause breakdown and other hazards.
- This product shall not be placed in the following environment: near the heat source and open and dying fire, wet, unobstructed, with smoke and pollution, too high or too low temperature;
- Please try to avoid the places with bad effects such as moisture, dust, salt, sulfur, etc., or it may cause fire, breakdown and other hazards.

**Warning:**

- This appliance must not be used by persons (including children) with reduced physical, sensory or mental capabilities or lack of experience and knowledge unless they have been given supervision or instruction.
- Please keep the nasal oxygen tube out of the reach of children to prevent the connecting tube from getting entangled in the neck and causing danger;

**Warning:**

- When this product is used by individuals at home, it should be used under the guidance of professionals or in accordance with the instruction manual;
- Do not use it with other therapeutic equipment at the same time;
- Do not place ME EQUIPMENT in a location where it is difficult to operate the disconnect device, as this may result in a safety risk; please read the instructions for use carefully and obey all instructions and warnings.

**Prohibition:**

- Please do not disassemble the machine. Non-professionals or authorized personnel of the company are not allowed to disassemble, modify or repair this product.

- Dry the dust on the main engine and power plug regularly. If there is dust on the plug, it will lead to fire because of bad insulation caused by moisture;
- Do not use it in the presence of electromagnetic interference;
- The wires and power supply head must not be damaged. Use after damage may cause electric shock, short circuit, or fire. For repairs of the wires and power supply head, please contact the service hotline.

## 2. Technical parameters

Hydrogen Oxygen Health Care Machine		
Specification and model	YSR-450A	YSR-900A
Mixture ratio of hydrogen and oxygen	Hydrogen 66.6%, Oxygen 33.3%	
Output flow	450mL/min, 300mL/min	900mL/min, 450mL/min
Rated voltage	230V 50/60Hz	
Rated input power	160 W	260 W
Hydrogen output pressure	< 5 kPa	
Overpressure protection value	> 5 kPa	
Electrolytic cell technology	Hydrogen Production by Electrolytic Water with SPE Proton Exchange Membrane	
Hydrogen production water	Distilled water (purified water)	
External Dimension (L*W*H)	210*430*425mm	
Complete Machine Net Weight	9.0kg	9.2kg

## 3. Environmental conditions of the operation place

- 1.Environment temperature: 5°C~40°C;
- 2.Relative humidity: ≤ 90%;
- 3.Atmospheric pressure: 86 kPa~106 kPa;
- 4.Power supply voltage: AC 220V ± 10%, 50/60Hz;
- 5.The use of distilled water or purified water shall meet the requirements of GB17323-1998;
- 6.No direct sunlight, and no open fire;
- 7.No large dust and conductive ions, and no acid, alkali and other corrosive gases;



- Note: When the storage temperature is below 5°C, the product shall be placed in the environment with normal working temperature for more than 4 hours before use.
- When the environment temperature is 5 ~ 10 °C, the machine will be in the preheating mode when it is first started, and the output flow rate of the preheating mode is low.

## 4. Instructions for Use



- |   |                                |
|---|--------------------------------|
| 1.Before starting operation for the first time, please open the filler cover to add distilled water or purified water and make sure to meet the water level requirement of the water tank in time. Wait for 15 min after adding the water before starting operation.  | 15min                          |
| 2.During use, please use the water tank observation window on the right to confirm that the water volume in the water tank should be controlled between the minimum water level (Min) 1600mL and the maximum water level (Max) 2500mL. Do not exceed the maximum water level;<br>3.During use, if the water level in the water tank is lower than the lowest water level, the water shortage indicator light on the host will light up/voice will prompt. At this time, water needs to be added to the normal water level range to ensure the normal operation of the product;  | water level (MIN) (MAX)        |
| 4.Water quality requirements: It is required to use pure water or distilled water for electrolysis. When the water quality TDS is greater than the set value, an alarm is triggered; hard ions (such as calcium and magnesium ions) in unqualified water will deposit, block the electrolytic cell, and cause damage to the electrolytic cell;<br>Note: If the machine uses non-specified water, it will not be able to enjoy the three-guarantee service.  | Water quality                  |
| 5.When the product is out of service for a long time or needs to be transported, it is necessary to discharge the water from the water tank.<br>6.During the process of using the product, if the water source that does not meet the requirement is used, it can be used normally only by carrying out the function of rinse drainage many times, adding new water that meets the requirement, and ensuring the water quality monitoring is normal.<br>7.When the product is in use, the electrolytic cell and water tank shall be kept clean, since the long-term use of the product may lead to the breed of microorganism, resulting in turbid water and affecting the hydrogen oxygen production and service life of the product. Rinse Drainage shall be carried out according to the prompt of water quality monitoring function during the use of the product.<br>8.It is recommended to change the water in the water tank every 1 to 2 weeks (use new water). | Cleaning and drainage function |
| 9.The small holes on the filler cover of the water tank of the product are the outlets of the water tank, which cannot be blocked, and the filler cover of the water tank cannot be arbitrarily replaced!<br>10.During the process of transportation, water shall not be stored in the water tank to prevent water spillage from damaging the electrical components;<br>11.The filter element has a lifespan of one year and needs to be purchased separately. The filter element purifies the water quality to better protect the water used by the machine;   | Water tank                     |

12. During the use of the product, the two sides and the rear side of the main engine shall be kept above 15cm with other objects, and the cooling window shall not be covered, so as to prevent the blockage causing too high temperature and causing downtime or product failure;

**kept above 15cm**

13. If any adverse reactions occur or appear during the use of this product, please immediately discontinue the use and contact the supplier of the product or doctor.

**contact**

## 5. Product Introduction and Operation Instructions

### 1-Unpacking

1. Please handle with care when unpacking and transporting;
2. Check the carton or other packaging for obvious damage. If there is any damage, please notify the transporter or dealer in time;
3. Take out the product and accessories and check whether the accessories are complete according to the packing list;
4. Check the outer surface of this product for damage such as chips and dents. If there is any damage or incomplete accessories, please notify the transporter or dealer in time.

### 2-Diagram of the complete machine

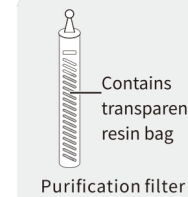
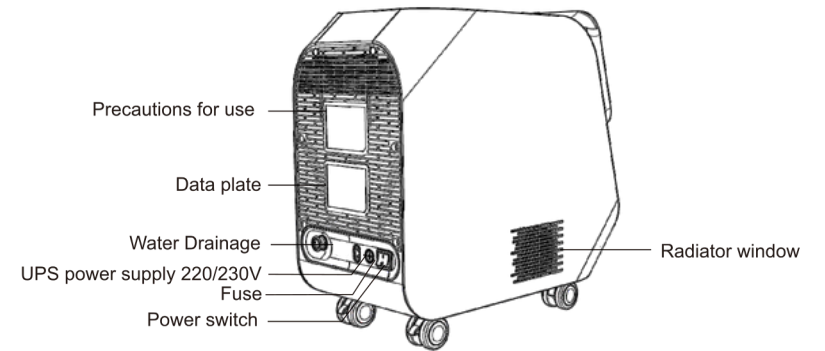
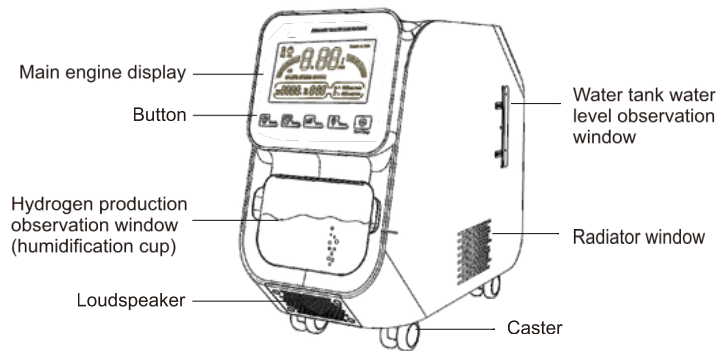

Installation steps of the filter element: Open the water tank cover of the machine, take out the silicone plug, place the purification filter element in the water tank, and close the water tank cover (the purification filter element needs to be kept moist with pure water for storage and transportation).

Note: The purpose of using the purification filter element is to filter the water in the water tank, remove ions in the water, and achieve the purpose of water purification, so as to better protect the water requirements of the machine.

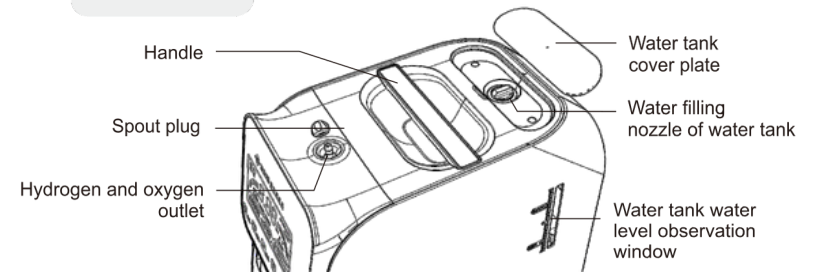

### 3.Start-up instructions

#### Step 1 Connect the power supply

- 1.Take out the power cord and connect it to the power supply, press the power switch to " | ", the green power indicator light will light up, and there will be a voice prompt;
- 2.The display screen lights up: the time set during the last startup is regularly displayed, and the accumulated running time of the machine is displayed at the same time; the current output gas pressure value is displayed, the default voice is on, and the running icon is always on.

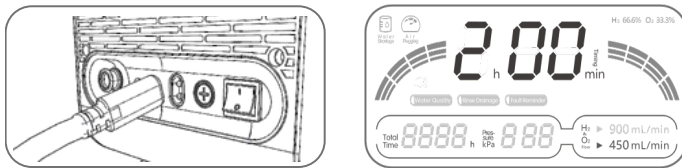

#### Step 2 Water filling of the water tank

- 1.Open the small cover marked "OPEN" on the top of the main unit, then unscrew the water tank cover and remove the silicone plug; please add distilled or purified water; confirm that the water level requirements of the water tank are met. You can look through the water tank observation window on the right side of the product. The water tank is marked with a water level. The upper and lower limits need to be controlled between the lower limit of the water level (Min) and the upper limit of the water level (Max). Do not exceed the maximum water level!
- 2.When the user fills the water tank with water, the premise is that the device is powered on and when the water level does not reach the minimum water level, the host An alarm will sound, and the system will give a voice reminder: "Water shortage reminder, please check the water level in the water tank and add an appropriate amount of distilled water or pure water. "

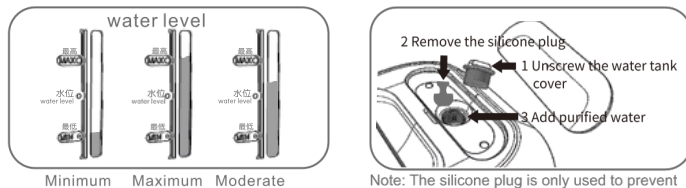

Note: The silicone plug is only used to prevent water overflow during transportation and is not used normally.

- 3.If the water in the water tank exceeds the maximum water level, cleaning and drainage are required to prevent the air outlet from being blocked and overflowing, causing abnormal operation of the host. First open the drain pipe at the rear of the host, then open the drain pipe hole plug, and long press the "Clean and Drain" function to drain excess water.

4. Place the purification filter element in a water tank that has been filled with water (the filter element should be replaced once a year);

Note: The water tank used for machine operation is recommended to be replaced every 1 to 2 weeks.

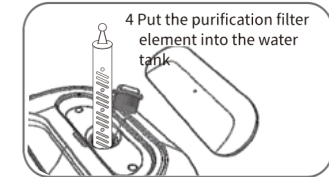

#### Step 3: Hydrogen production observation window (humidifying cup)

- 1.Remove the humidification cup on the front of the main unit with both hands, open the white silica gel round cover at the top, pour an appropriate amount of distilled water or purified water, and ensure that the water level does not exceed the maximum water level of the standard limit; cover the upper cover, check the sealing of the upper cover; and then put the humidifier in. Connect the chemical cup to the host and confirm that it is installed in place to prevent loosening and air leakage.

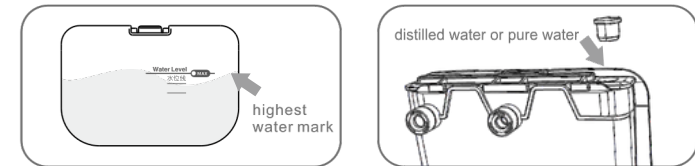

Note: It is recommended to replace the water in the humidification cup once a week.

#### Step 4: Turn on the computer for the first time

- 1.Rinse Drainage: for the first start-up of filling water in the water tank, it is required to carry out the "Rinse Drainage" function. Open the rear drainage hole plug of the main engine, refer to the operation instructions of the "Rinse Drainage" function button, and discharge a small of water and air, so as to ensure that the waterway of the electrolytic cell in the main engine is clear.

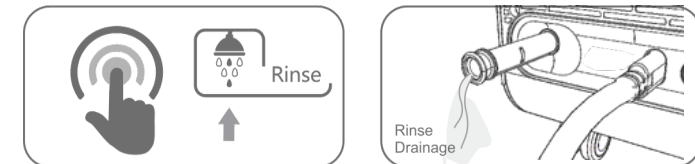

### Step 5 Connect the hydrogen oxygen tube

1. Take out the nasal oxygen tube and water collector, install the water collector on the water collector holder, then connect one end of the water collector connecting pipe to the air inlet (thick) on the water collector, and the other end to On the hydrogen and oxygen gas outlet on the main unit (connect according to the arrow instructions);
2. The connecting end of the nasal oxygen tube is connected to the air outlet (relatively fine) above the water collector. The Nasal Oxygen Tube is used for the user to wear and suck in hydrogen gas;
3. Connect the product to the water collector before each use. Check and clean the water collected in the water collector or the water condensed from the water vapor during the use of the product.

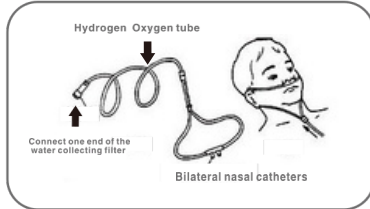
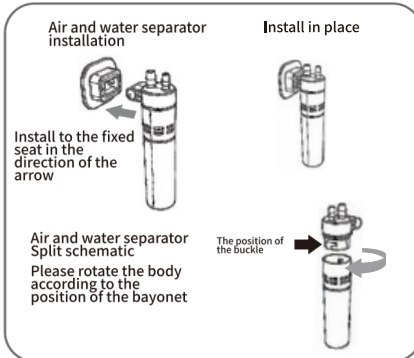
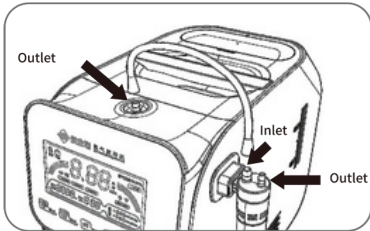

The use of three-way connection tubes is prohibited. It is prohibited for multiple people to use at the same time.



- 1) The nasal oxygen cannula is a consumable accessory. For personal hygiene, please clean and disinfect it before use;
- 2) Water vapor will accumulate in the nasal oxygen cannula during use, which is normal. Before use, you can shake the nasal oxygen cannula to remove the water droplets or water vapor.

### Step 6: Power on, set up and run

After pressing the start button, observe whether there are bubbles in the humidification cup. If bubbles are generated, it means that the product is working normally. Users can operate and use this product correctly according to the instructions.



1. When starting up with water for the first time or when it has not been used for a long time, you need to wait 15 minutes after filling the water tank before running the hydrogen production function to ensure that the electrolyzer is not short of water;



2. The water tank should be kept clean for a long time. Please clean and drain it regularly according to the water quality requirements, and replace the designated water.

### 4. Key operation instructions

After unpacking: After filling water for the first time, you need to wait for 15 minutes before starting operation to ensure that the electrolyzer is not short of water.

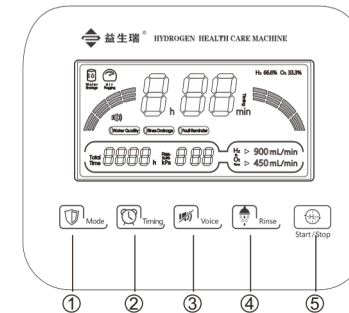

#### 1-"Mode" key

- \* Press this button, YSR-450A model sets the hydrogen and oxygen flow rate to switch between 300/450; YSR-900A model sets the hydrogen and oxygen flow rate to switch between 450/900; Depending on the model, the LED screen will display accordingly. When the voice is on, every time this button is pressed, there will be a corresponding voice announcement. hint;
- \* Press and hold this button to switch between "night mode" and "normal mode"; "night mode": adjust the brightness of the screen indicator light Dark, humidification cup and water tank ambient lights are turned off.

#### 2-"Timing" key

- \* Press this button to set the selectable time, switching cyclically between 30 minutes, 40 minutes, 50 minutes and 1~8 hours, step by step It lasts for 1 hour and is equipped with voice prompt function. Time memory function, records the last startup operation every time it is turned on the set time.

#### 3-"Voice" key

- \* Press this button to switch between voice on and voice off. The corresponding voice icon on the LED screen will light up and go out. Lights up to indicate that the voice is on and has a voice prompt function.

#### 4-"Rinse" key

- \* Press this button and the voice will broadcast: "Flushing function"; When turning on the cleaning and draining function, you need to pull out the drain pipe first, open the drain pipe hole plug, and then press and hold the cleaning function button for 3 seconds to drain the water (note that the drainage is contained and handled, and it is not drinkable). Press and hold this button for 3 seconds to turn on the cleaning and draining function. At the same time, the voice broadcast: "Cleaning has started", and the "Cleaning and Draining" icon on the LED screen flashes;
- \* Press this button again to turn off the cleaning function, and the voice will broadcast: "Cleaning off".

Note: During the operation of the product, it needs to stop running before the cleaning function can be turned on.

### 5-“Start/Stop” key

\* Press this button to start and stop the running function, and there will be a voice prompt at the same time. When the hydrogen and oxygen mixture is turned on, the running icon starts to flash, and the "Hydrogen 66.6% Oxygen 33.3%" icon lights up at the same time; the hydrogen and oxygen mixture function stops. , the running icon is always on, and the "Hydrogen 66.6% Oxygen 33.3%" icon is extinguished at the same time.

### 5.Power socket description

- 1) Cleaning the drainage hole: When the host water tank performs the cleaning or drainage function, you need to pull out the drainage hole plug, stretch out the drainage pipe, and press the "Clean" function button to drain the water. Pay attention to the containment and treatment of the drainage. Do not drink;
- 2) Power socket: Connect the product to AC220/230V;
- 3) Fuse: fuse holder;  
Built-in F5AL250V (5\*20mm) fuse tube;
- 4) Power switch,○ turns off, I turns on;

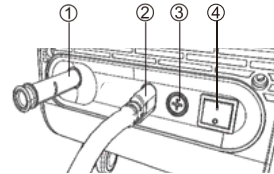

#### Notice

How to replace the fuse:

- a. Turn off the power and unplug the power cord from the power socket;
- b. Use a Phillips screwdriver to rotate and remove the fuse holder;
- c. Replace the fuse specification to F5AL250V. If the fuse burns out again after replacing it, please contact our maintenance center.

### 6.Operating Instructions

- 1) Timing function: The product operates in a countdown mode. For example, if the time is set to 2:00 hours, it will automatically decrease every 1 minute until the countdown is over. The device will automatically stop running and the system will return to the initial default state.
- 2) During operation, the mode, scheduled time, and voice function buttons can be set without the device shutting down.
- 3) During operation, press the "Clean" button, and the voice prompts "Please stop running first." The "flush and drain" function can only be turned on when the equipment stops running.
- 4) When the cleaning and draining function is turned on, the mode, timing, and voice button setting functions are normal. If the "Start/Stop" button is pressed at this time, the voice prompts "Please turn off the flushing function first". Only when the device turns off the flushing and draining function, Only then can the function of producing hydrogen and oxygen mixture be started;
- 5) During the use of this product, if you use it continuously for 2 hours or more, each time the continuous operation increases by 1 hour, the system will give a voice prompt: Warm reminder, you have used it continuously for 2 (maximum 8 hours) hours. Don't sit still for long periods of time. Proper exercise is good for your health!

## 6. Maintenance and Cleaning

### 1.Inspection of product status in use

- 1) During the process of using the product, attention shall be paid to the inspection of the following status:
  - \* The display content shall be correct;
  - \* The key operation shall be normal;
  - \* During use, the water level of the water tank and the observation window shall be normal.
  - \* Hydrogen production observation window shall be normal.
- 2) If an exception is found in the above inspection, the following treatment methods can be adopted:
  - \* Stop using and contact the local dealer;
  - \* Consult our after-sales service center.

### 2.Daily maintenance and cleaning

- 1) The power cord should be free from deterioration, deformation, or damage.
- 2) The water in the water tank and humidification cup should be cleaned and replaced frequently to ensure that the product meets the water quality requirements. It is recommended that the water in the water tank be cleaned and replaced once every 2 weeks, and the water in the humidification cup is recommended to be cleaned and replaced once a week;
- 3) When cleaning the humidification cup, first rinse it with light detergent, then rinse it with clean water to ensure hygienic use;
- 4) When cleaning the humidification cup, do not touch the internal filter element to prevent it from falling off;
- 5) When not in use for a long time, the water in the water tank and humidification cup needs to be cleaned and emptied to prevent bacteria from growing if it is not used for a long time;
- 6) The nasal oxygen cannula is a consumable accessory. For personal hygiene, please replace it frequently;
- 7) The host does not require professional maintenance. It only needs regular cleaning and wipe off the dust on the surface of the host with a soft cloth. And keep the host dry, and do not allow liquid to penetrate into the host;
- 8) The heat dissipation windows and back panel on both sides of the host can be lightly brushed with a small brush to avoid accumulation of dust and affecting the heat dissipation of the machine. and use;
- 9) Maintenance and maintenance of the equipment is prohibited during patient use.

### 3. Inspection shall be performed before re-use after long-term non-use

- 1) Please wipe off the dust or dirt on the power cord, power plug, and main unit, and keep them clean;
- 2) Please confirm whether the buttons and indicator lights are functioning properly;
- 3) After completing the above inspection, please follow the initial boot steps. Please refer to the instruction manual for details.

## 7. Transport and Storage

### Packaged products should be transported and stored under the following environmental conditions.

- 1) Ambient temperature: 0°C~55°C;
- 2) Relative humidity: no more than 93%;
- 3) No corrosive gas and well-ventilated environment;
- 4) Before transportation and storage, ensure that the product packaging is intact and meets transportation and storage standards.



- This product should be stored in a room without strong sunlight, corrosive gases and well-ventilated. During transportation, avoid severe shocks and inversion;
- When the storage and transportation temperature is lower than 0°C, the product should be placed in a normal temperature environment for 48 hours before use, and then operated according to the instructions to avoid being affected by the environmental temperature of storage and transportation, which may cause product failure.

## 8. Common faults

When the equipment detects a fault, the machine will stop running, the LED screen will display the corresponding fault code, the fault icon will flash, and there will be a buzzer and voice broadcast prompt function.

Serial No.	Fault Phenomenon	Inspection the Reasons	Maintenance Guide
1	When the power supply is turned on, the buzzer of the mainframe has no sound, the screen is not bright, and the product can not run.	1-Poor contact between power cord plug and socket	Recheck the plug-in socket
		2-No power output from the socket	Move to a socket with power output
		3-Fuse blown	Replace the fuse
2	Hydrogen-oxygen outlet has no flow output	1-Air system leakage	If such failure is found, stop using immediately. It must be sent to the manufacturer for repair and replacement. Do not disassemble it by oneself! Otherwise, at your own risk!
		2-Poor sealing of air and water separator	
		3-The system power supply is damaged	
3	Mainframe does not work, and alarm sounds; Display screen displays "E01"	It is triggered when the water level is below the minimum water level limit;	Water shortage reminder, please check the water level of the water tank and add proper amount of distilled water or purified water;
4	Mainframe does not work, alarm sound ; Display screen display "E02"	Air plug: it is triggered when the hydrogen pressure is greater than the set maximum pressure set;	Air plug remind, please check whether or not the accessories are folded or pressed, or blocked!
5	Mainframe does not work, alarm sound ; Display screen display "E03"	Water quality: it is triggered when water quality is not up to standard;	Water pollution reminder: the current water quality does not meet the requirements, please timely replace "distilled water" or purified water;
6	Mainframe does not work, alarm sound ; Display screen display "E04"	Overheat: it is triggered when the temperature exceeds the set value;	Check whether the cooling windows on both sides of the mainframe are blocked, and start it again after cooling;

Serial No.	Fault Phenomenon	Inspection the Reasons	Maintenance Guide
7	Mainframe does not work, alarm sound ; Display screen display "E06"	Improper external operations lead to the product triggering the safety protection device, and please operate and use the product correctly.	Please follow the instructions and operate in correct way, and read precautions.
8	Mainframe does not work, alarm sound ; Display screen display "E07"		
9	Mainframe does not work, alarm sound ; Display screen display "E08"	The low temperature alarm is triggered due to low ambient temperature	Place of use Ambient temperature: 5°C~40°C
10	During the use of the product, there are many fogs or water droplets in the hydrogen-oxygen tube.	1-Due to the large difference between the internal temperature and the ambient temperature during the long-term operation of the mainframe , water mist and water droplets are produced; 2-The water collection filter is too full; 3-The water in the hydrogen production observation window is too full, which has exceeded the maximum water level line; or the water temperature of observation window is too high;	Remove the water collector filter, open the filter, and pour out the water stored inside. Discharge water droplet in the hydrogen-oxygen tube or dry it. Wait for the mainframe to rest for a period of time, and restart it;  Remove the hydrogen production observation window and pour out the excess water.
11	If water is found to flow out of the gap at the bottom of the mainframe.	Silicone hose is aging, and waterway interface is loosening	Send it to the manufacturer for inspection, repair or replacement



If other faults cannot be eliminated, please contact the dealer or our company's service hotline.

**Other faults:**

- 1.Non-professionals or authorized personnel of the company are not allowed to disassemble, modify, or repair. If there is any other failure with this product, you need to contact the local dealer or the company's technical service department;
- 2.After tearing off the warranty label on the back of the console, free warranty will no longer be provided.

## 9. Pollution Control Labels of Electronic Information Products

### 1-Table of contents of toxic or hazardous substances or elements.

Component and Part name	Toxic and hazardous substance or element					
	Lead (Pb)	Mercury (Hg)	Cadmium (Cd)	Hexavalent chromium (Cr6+)	Polybrominated biphenyls (PBBs)	Poly brominated diphenyl ethers (PBDEs)
Plastic shell	0	0	0	0	0	0
Circuit board	X	0	0	0	0	0
Connecting line	0	0	0	0	0	0
Metal components	0	0	0	0	0	0
Label class	0	0	0	0	0	0

Note: circuit board includes printed circuit board and its components and parts, such as solder, resistors, capacitors, integrated circuits and connectors, etc. The connecting wire includes copper wire and its raw material composed of it, such as solder and insulating material, etc.

0 : It indicates that the content of the toxic and hazardous substance in all homogeneous materials of the components and parts is below the limit specified in the SJ/T11363-2006 standard.

X: It indicates that the content of the toxic and hazardous substance in at least one homogeneous material of the components and parts exceeds the limit requirements specified in SJ/T11363-2006 standard.

Note: for components and parts marked with "X" above, some contain hazardous substances beyond the standard due to the limitation of the current industry technical level, so it is unable to achieve reduction or replacement temporarily.

## 2.Environmental Protection Service Life



The number in this logo indicates that the environmentally friendly use period of the host under normal use is 10 years.

## 3.Product expiry date instructions

This product is a health electronic product, and its service life is usually related to the following factors:

- 1) Usage environment, such as power supply stability, temperature, humidity, dust, etc.;
- 2) Usage intensity, such as the duration of each use, number of uses, usage intensity level, etc.;
- 3) Maintenance conditions, such as regular dust removal, cleaning, inspection and maintenance, etc.;
- 4) When used under normal conditions, the product has a service life of 10 years. If it still needs to be used after 10 years, it should be tested.

## 4.Environmental protections

- 1) Please do not dispose of this device and its accessories as ordinary domestic waste;
- 2) Please comply with local regulations for the disposal of this device and its accessories and support recycling operations.

## 5.Packaging recycling label



This sign indicates that the packaging of this product is recyclable and the material is corrugated cardboard.

# 10. Liability of Manufacturer

1. If the produced product is identified as not meeting the standard requirements, our company will be responsible for repair, replacement and return.
2. If defects in the product cause other property losses or personal injuries, our company will bear the corresponding responsibility. However, our company will not be responsible for any of the following circumstances:
  - 1) When the product is put into use, the defect causing damage does not yet exist.
  - 2) The purchaser and operator did not read the instruction manual carefully and did not use it in accordance with the instructions.
  - 3) Failure to comply with product installation, use, maintenance, transportation, storage, etc. regulations, resulting in product, personal, and property losses.
3. Product quality problems that occur within the specified quality warranty period will be repaired for free for the user and corresponding technical services will be provided. Please refer to the warranty card for the warranty period.

# 11. Packing List

## 1. Precautions for unpacking

- 1) When unpacking, the front of the packaging box should be facing up and not turned upside down;
- 2) Check the integrity of the outer packaging box;
- 3) When unpacking and transporting, please handle it with care to avoid damaging the machine;
- 4) The user accepts the product according to the packing list.

## 2. Packing configuration list

Mainframe-----	1 unit
Power supply cord-----	1 pc
Hydrogen-oxide tube-----	2 pcs
Water collecting filter-----	1 pc
User manual (including warranty card)-----	1 pc
Certificate of Product-----	1 copy
Fuse (fuse) -----	2 pcs
Purification filter element -----	1 pc

## Notice

- 1) This list is the company's factory standard configuration (excluding optional accessories), and is subject to change without prior notice;
- 2) The water collector and humidification cup are consumables and need to be replaced regularly; starting from the period of use, it is recommended to replace them at least once a year.



[www.HydrogenTherapyH2E.com](http://www.HydrogenTherapyH2E.com)

# WARRANTY CARD

Please take good care of the warranty card for future reference.

customer support: 400-808-1531

Product name	Specification type	Lot number
Name of client	Contact number	Date of purchase
Client address		
Address of sales company		
Address		Contact number
Failure phenomenon		

**In order to protect your legal rights and avoid your worries, we promise the following warranty service to you, and provide you with Standard Warranty Service (only in China).**  
**Warranty object** The warranty is limited to consumers who purchase the product through legal sales channels.

### Warranty commitment

Product warranty strictly abides by the national three guarantee regulations. Within one year from the date of purchase, you will receive free warranty service for any product problems that occur during normal use.

- It involves the main components (including Electrolyzer, circuit board, display screen, power module, etc.): After our technicians confirm the quality problem of our products, we will provide one-year warranty service. Can NOT replace the same model of parts, can only upgrade, according to the market at the time of the charge for parts price differential; if upgrade involves the replacement of other parts, other replacement parts to pay in full;
- Concerning fragile parts (Humidification Cup, water collector, etc.): except for the cases of artificial damage and normal wear and tear, free warranty replacement within six months, seven to twelve months warranty, free service charge, only charge for the cost, after more than one year will be charged for the Service Charge;
- If replacement parts are needed, the warranty period of the replacement parts shall be extended for 3 months as of the date of repair.

### Maintenance tips

If in the maintenance process needs to replace the fitting, then only charges the fitting the cost fee. Free maintenance period, the products of the round-trip freight are borne by customers.

### Points to note for exchange

1. Our company's products undergo rigorous testing before leaving the warehouse. Please be sure to read the instructions carefully or consult our technical support staff when operating, or have our sales staff assist customers in the operation;
2. For product failures, our company provides free replacement services within 15 days. After our technical support staff confirms that there is a product problem, the customer should first send the faulty product back to our company by logistics or express delivery. The return freight and all other costs incurred are borne by the customer.

Note: Any of the following items are not covered by free warranty or replacement, even if the equipment is under warranty, the company will charge the relevant maintenance fees.

- Due to manual crash, equipment soaking in water, etc.;
  - Damage caused to the equipment by the user's own disassembly, repair or modification;
  - The equipment information is incomplete, such as fragile paper and date paper that have been removed, damaged or altered;
  - Failure and damage caused by force majeure factors (such as fire, earthquake, ice and snow, lightning strike, flood, etc.).
- Human failure caused by the user not operating the device according to the instructions for use;  
 ■ Damage caused by failure to follow the equipment instructions, improper maintenance and storage;  
 ■ Other problems and failures caused by abnormal use;  
 ■ If the user modifies the equipment or changes the usage method and purpose, the user shall bear all responsibilities.